



CI0618 SMA/Female Isolator 6 – 18 GHZ

Rev 000

Electrical	
Frequency	6 – 18 GHZ
VSWR	1.50
Impedance	50 Ohms
Isolation	12 dB Min
Insertion Loss	1.2 dB
Power Handling	10 Watts Forward / 2 Watts Reverse
Mechanical	
SMA Interface per	MIL-STD-348B
Operating Temperature	+25°C
Materials	
Body(SMA)	Au Plated Stainless Steel
Contacts	BeCu
Contact Plating	Au 50μ" Min
Dielectric	PTFE
ROHS Compliant	



Outline

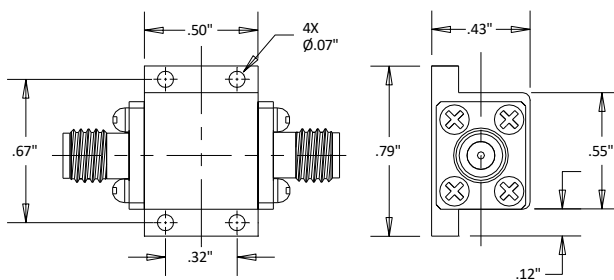

Dimensional Tolerances

.X	±.030
.XX	±.010
.XXX	±.005

Typical Data

